

Aquaguard[®] select

— WATER SOFTENER —

GET RID OF PROBLEMS DUE TO HARD WATER.



18602661177



SMS "<REQ>" to 80822 99333

Now buy online on www.eurekaforbes.com | www.facebook.com/EurekaForbes
| www.twitter.com/EurekaForbes • Email: deepa.customer@eurekaforbes.com

Eureka Forbes Limited: B1/B2, 701, 7th Floor, Marathon Innova Marathon NextGen, Off Ganpatrao Kadam Marg, Lower Parel,
Mumbai - 400 013, India. Tel: +91 22 3044 9700, 3044 9888 • Fax: +91 22 3044 9701



Environment Protection:

"PROTECTION" has always been our motto and guiding principle. We care for the environment. We urge you to recycle the packaging material or take it to the nearest recycling facility rather than dispose of it with the rest of your waste.

Your appliance has been designed to work for many years. However, should you wish to upgrade or replace your old product, remember to help protect the environment by disposing of it at your local e-waste disposal centre. Should you have queries, the nearest authorized service centre of Eureka Forbes will be able to guide you.

Allow us to become your environmental partner; together we can make the world a cleaner place.



USER MANUAL- AWS 600

Dear Customer

Thank you for welcoming Aquaguard Select Water Softener 600 into your home. Water Softeners efficiently remove excess calcium and magnesium salts dissolved in water, to make hard water soft.



to equipment failure, breakdown or accident, fire or operation, or utilization of the goods otherwise than in accordance with the User Manual by or due to any other cause or circumstances beyond the control of the company.

- f) The company's liability, under this warranty, shall in no event and under no circumstances exceed the price paid by the customer to the company for the goods stated in the invoice.

General

For the purpose of this warranty, the following expressions shall have the following meanings respectively.

1. The "Goods" shall mean the goods described in the order form.
2. The "customer" shall mean the original purchaser of the goods from the company.
3. The "company" shall mean "Eureka Forbes Limited".
4. General terms and conditions shall mean the terms and conditions agreed upon by the customer and the company printed on the order form.
5. "Invoice" shall mean the invoice issued by the company to the customer describing the goods and indicating, inter alia, the total purchase price thereof and name of the customer.
6. "User Manual" shall mean the instructions for installation, use and maintenance contained in the leaflet supplied by the company.

Post-warranty

1. The customer may be offered a yearly service contract at the prevailing company rates and terms.
2. In case the customer does not wish to enter the service contract, he has the option of calling the company's service centre and having the Aquasoft Water Conditioner serviced on an actual basis i.e. by paying the labour cost and the spares needed to attend to that service/complaint call at the prevailing company rates. Such service will be rendered by the company in towns/places where the company has its service centres.
3. The company will provide free servicing of the goods brought to its service centre by the customer, provided that all expenses of transporting the goods to and from the service centre shall be borne by the customer directly.
4. If during such servicing it is necessary for the company to replace or repair the defective components or parts, the customer shall be required to pay the same as per the company's prevailing price list.
5. Eureka Forbes Limited reserves the right to offer an Annual Maintenance Contract/ ensure availability of spares only up to 7 years from the date of invoice.

WARRANTY TERMS AND CONDITIONS

The goods are warranted against defects arising from faulty designs, workmanship and materials 12 months from the date of installation or 15 months from the date of sale, whichever is earlier, subject to the following conditions.

1. The customer will notify the company, in writing, promptly of any defects noticed and give the company or its authorized agent adequate opportunity to inspect, test and remedy them for which the customer will deposit the goods, if so required by the company, with the company's office/service centre along with the original invoice, in the city when they are sold.
2. The inspection and test reports of the company's office/service centre will be final and binding under the warranty for determining defects, repairs/alterations required or carried out or certifying work of the goods thereafter.
3. In case of any service requirement post-installation, please contact the company's service centre.
4. The company or its authorized agent will be entitled to retain any defective part replaced under the warranty.
5. Notwithstanding anything to the contrary contained or implied by this warranty.
 - a) The company's liability under this warranty shall be limited to the first of the goods by the company to the customer and will not apply or extend to any secondary sale of goods by the customer.
 - b) The company's liability under this warranty shall be limited only to defects in the goods which occur under the condition of normal operation of the goods and their proper and prescribed use. The warranty does not cover or extend to defects which are determined by the company or its authorized agents or resulting from or attributable to negligence, abuse, misuse, faulty care, operation or maintenance or repairs, alterations to the goods or any part thereof by others or the use of the goods on electrical supply for which they are not designed or damage caused by lighting or other electrical disturbances or interruptions.
 - c) The company's liability under this warranty shall remain valid only if the goods are duly installed by the company or its authorized agency at the location specified in the invoice and such installation is undertaken by the company or its authorized agent or franchisee.
 - d) Consumable items like sediment filter and regeneration media are not covered by this warranty.
 - e) The customer will have no claim against the company, its employees and its authorized agents or franchisee under or pursuant to this warranty in respect of death or injury to the customer or any other person or loss or damage to any property caused by or due

Table of Contents

Introduction.....	3
Installation Condition	3
Installation Illustration.....	4
Usage and Maintenance.....	6
Installation Guide.....	7
Technical Specifications	8
Warranty Terms and Conditions	9 -10

- Please read this User Manual carefully before operating the unit
- Keep this User Manual for future reference

Introduction

- Designed for bathing, it removes hardness to provide high quality soft water which can keep your skin smooth, healthy and beautiful, and also makes hair look shiny
- No electricity required. Safe and reliable
- Nice and compact design, space-saving, and flexible design
- Regeneration procedure is two steps only, more efficient for water usage
- Quick connections for plumbing system, easy to install and take apart
- Standby mode, longer lifespan and more stable

Installation Condition

- 1 A water faucet together with an individual shower head with a flexible water hose are required for this softener. All connections thread would be BSP 1/2 inch.
- 2 Install the system in the bathroom with a floor drain, and place it on the floor of the bathroom.

Installation Illustration

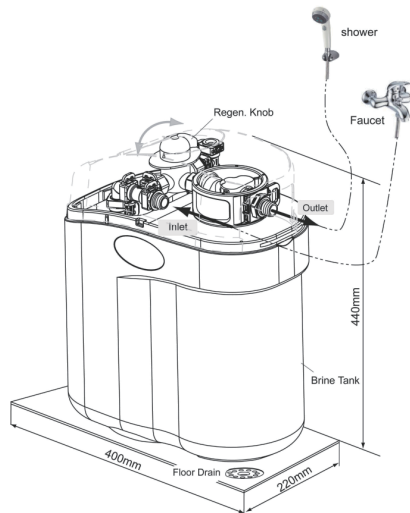

Technical Specifications*

Model	Aquaguard Select Water Softener 600
Input Water Temperature	10 - 40°C
Input Water Pressure	1 - 3 Kg / Cm ²
Service Flow Rate	500 LPH
Max. Salt Storage	8 kg.
Net Weight	≤8 kg
Dimensions (H×D×W)	440×200×360 mm
Maximum Input Hardness	700 - 800 ppm

*Technical Specifications are subject to change without prior notice.

TROUBLESHOOTING

Problem	Cause	Solution
Water is not soft enough.	Needs regeneration or regeneration period is not long enough.	1.Delay regeneration time. 2.Change larger injector. <i>Note: Ensure half water in the brine tank.</i>
Too much brine in the tank.	Water pressure is too low, and the brine valve has stopped working.	Check and correct the working of the brine valve.

Installation Guide

5. Important Note

- a. This system is only for bathing and washing & not for drinking, and should be connected to the shower. Company will not assume responsibility for any losses caused by improper installation or usage.
- b. After installation, please check out all the connections whether there is a leakage or not, and deal with it promptly.
- c. Before going through the system, please control the hot and cold water mixture and at right temperature. If any water more than 60°C or higher flows into the unit, Company will not be responsible for any losses.
- d. If there is a big temperature difference between shower and environment, the outlet water temperature will stabilize itself after 1-2 minutes. We advise you to use it after the outlet water temperature is found to be stable, in case you feel uncomfortable during your bath.
- e. The system is only fit for non-iodized salts to regenerate. Company is not responsible for any damage or losses caused by inappropriate salt used.
- f. Please do not hit the tank and jacket with sharp or hard things, in case you cause damage to the equipments.
- g. Keep the slide cover closed during normal use to avoid sediment or dirty water into the brine tank.
- h. Please do not move the system when it is touching the floor, to avoid fraying the bottom of the tank.
- i. The system could also be used for a bathtub shower but it should be placed near the floor drain.

Installation Illustration

1. Place the system in the desired location, push the slide upwards, and take out the regeneration knob in an upward direction.

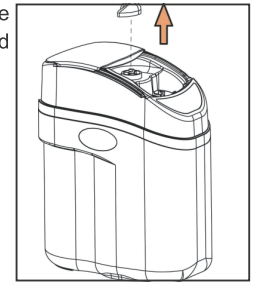

2. Stretch the rear cover upward from both sides with both the hands, and at the same time take off the cover in an upward direction.

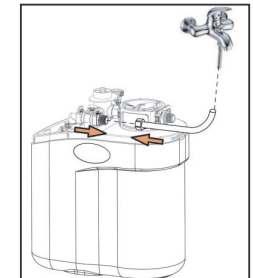
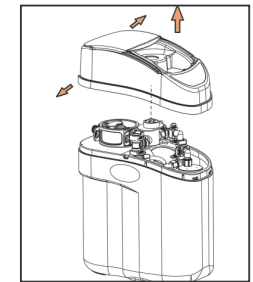

3. Connect the shower hose and the outlet of the system. When connecting the outlet, pull out the clip of fitting to take it off, and then the connector should be installed to its original position after connecting the fitting and hose. Make sure of the presence of washers during the connection of the hose. At the same time take off the cover in an upward direction.

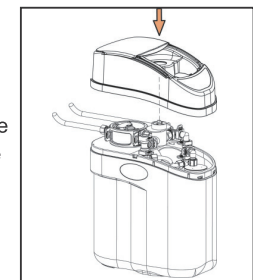

Installation Illustration

4. Install the cover back on the system, and make sure to align the knob and the hole on the cover. Keep the inlet and outlet hose free from stress.

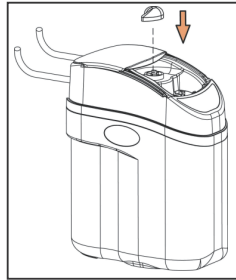

5. Inset the Regeneration (Regen.) knob back to the knob axis in the proper direction, and turn the knob to Service (Ser.) position, close the slide cover completely. The system is now on standby for use. (NOTE: Knob position based on the direction indicated by tiny outshoot of the knob.)

Note: For first use after the installation of system, it is recommended to turn ON the shower and keep the water flowing for 2-3 minutes, in order to clean up the plumbing and fittings.

Usage and Maintenance

1. Service

Regeneration button on Service mode, can provide softened water by shower for customer use.

Note: Under service mode, water flows from the shower and the system will refill automatically until it is finished and maintains the brine level.

2. Regeneration

Once the hardness of output water increases, it means Aquasoft ion exchange resin is exhausting and system needs regeneration. Ensure that Aquasoft Salt tank contains sufficient quantity of regeneration salt. For regeneration, spin the knob to the Regeneration mode. Open the drain valve & the brine will pass through the resin bed and allow to drain it for 20 - 30 minutes. When the regeneration process is over, change the knob to the service mode and flush out few litres of water through the drain valve and then close the drain valve. Now the Aquasoft is ready to deliver the soft water.

Note: Regenerating salt is made up of non-iodized food-grade salts, and will not harm you.

3. Add Salt

The system needs salts to regenerate its capacity. Please check the salt storage in time during usage and keep unmelted salt in the brine tank. Open the system's slide and put salt into the tank equably. It is recommended you add 3-4 kg salt in each exhausted cycle.

4. Maintenance

Needs no special maintenance under normal usage. If the system is not used for more than a week, it is recommended to rinse the system for 1-2 min. before usage, to ensure you get high quality fresh soft water.

